

CRYSTAL CROSSING METROPOLITAN DISTRICT

191 University Blvd.
#358
Denver, Colorado 80206
303-818-9365

December 20, 2022

Division of Local Government
1313 Sherman Street, Room 521
Denver, Colorado

DLG E-Portal

Douglas County Assessor
301 Wilcox Street
Castle Rock, CO 80104

assessors@douglas.co.us

Office of the Clerk and Recorder – Elections
301 Wilcox Street
Castle Rock, CO 80104

elections@douglas.co.us

RE: Digital Map - CRYSTAL CROSSING METROPOLITAN DISTRICT- LGID 65141

Sir or Madam:

In accordance with Section 32-1-306, C.R.S., this letter is to advise you that the boundaries of the above referenced District did not change during 2022, and the map showing the current boundaries of the District is on file with your office.

If I can be of further assistance, please contact me.

Sincerely,

/s/

Angela Elliott
District Manager

CRYSTAL CROSSING METROPOLITAN DISTRICT No. 4434

LOCATED IN SECTIONS 22 AND 23, TOWNSHIP 8 SOUTH, RANGE 67 WEST OF THE SIXTH PRINCIPAL MERIDIAN, COUNTY OF DOUGLAS, STATE OF COLORADO

LEGAL DESCRIPTION:

ALL OF HECHENDORF RANCH PLING NO. 1 (SECTION NO. 20060072) AND ALL OF HECHENDORF RANCH PLING NO. 2 (SECTION NO. 20077487), EXCEPT LOTS 1 AND 2, BLOCK 1, LOTS 1 AND 2, BLOCK 2, TRACT 8 AND TRACT P THEREOF, COUNTY OF DOUGLAS, STATE OF COLORADO.

I HEREBY CERTIFY THAT THE DISTRICT MAP SHOWN HEREON DEPICTS THE ATTACHED LEGAL DESCRIPTION, TO THE BEST OF MY KNOWLEDGE AND BELIEF, AND WAS PREPARED UNDER MY DIRECT SUPERVISION.

FOR AND ON BEHALF OF
 EMK CONSULTANTS, INC.
 JANE B. MCKENNA
 PLS 12405
 DISTRICT ENGINEER

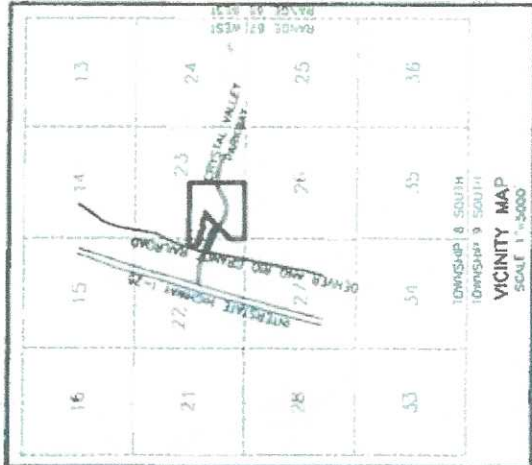
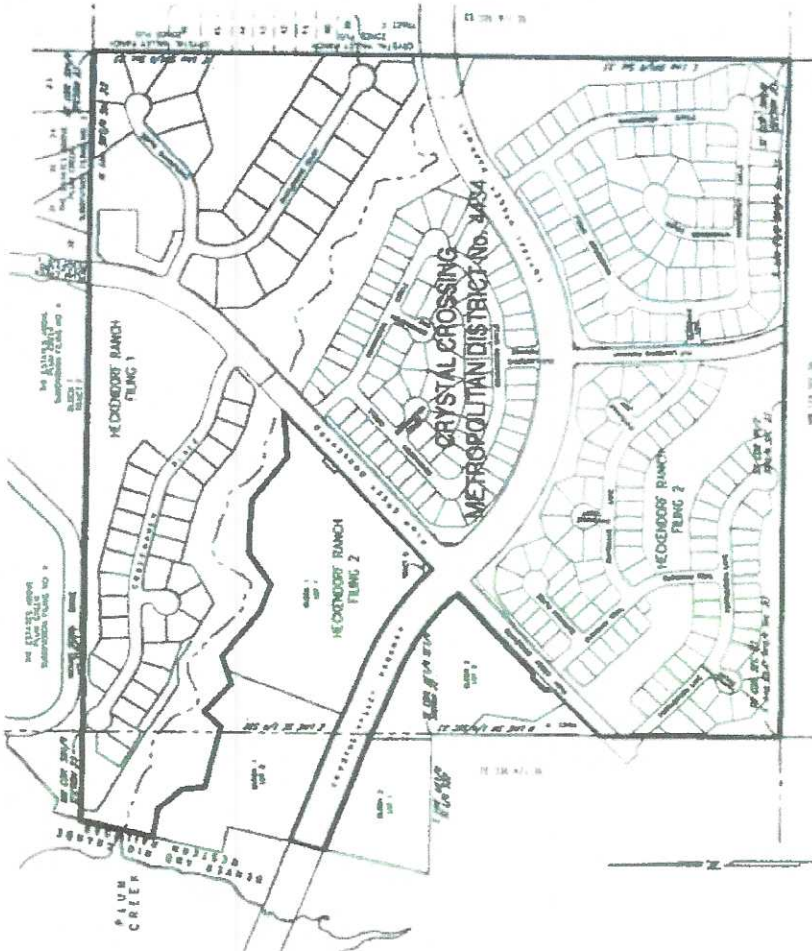

EMK CONSULTANTS, INC.
 DISTRICT ENGINEERS
 12405 PLEASANT VALLEY ROAD
 DENVER, COLORADO 80231-1240

DATE: 08/14/2010
 SHEET 1 OF 1